

# MBRP

---

## POWERSPORTS

132T207/1320309  
132Q106

2017+ Rev G4 850 ETEC  
2017+ Rev G4 850 ETEC, 2018+ Rev G4 600R ETEC

**EXHAUST SENSOR EXTENSION MUST BE INSTALLED ON 850 FREERIDE,  
BACKCOUNTRY, AND SUMMIT MODELS.**

**EXHAUST SENSOR EXTENSION MUST BE REMOVED ON 850 MXZ, RENEGADE, AND  
ALL 132Q APPLICATIONS.**

1. Remove both side panels and belt guard.
2. Loosen the clamp sealing the airbox to the hood and disconnect. It is located just above the secondary clutch.
3. Remove the 2 screws securing the gauge pod to the hood. Lift up the gauge pod and remove the storage bin.
4. Unplug the headlight connectors and intake air sensor. Gauge pod can now be pulled back out of the way.
5. Remove the 2 screws securing the hood assembly and slide it forward approx. 3" to disengage the locking tabs located at the front of the hood and at the gas tank. Lift the assembly off.
6. Remove the heat shield from the muffler inlet, followed by the exhaust springs.
7. Remove the muffler retaining bolt and spring. Angle the muffler to allow access to remove the exhaust sensor from the muffler.
8. Remove the muffler from the sled making sure the gasket stays on the outlet of the expansion chamber. Remove the 3 rubber bushings from the muffler as they will be reused.
9. **For 2019+ models**, the exhaust sensor needs to be rerouted. Remove the sensor wire from the stock ties and reroute the sensor toward the muffler inlet.
10. Insert rubber bushings on the MBRP Powersports muffler, only 2 will be used. Be sure the bushing with the metal sleeve is installed in the upper bracket.
11. Install the MBRP Powersports muffler in the sled. Reinstall the muffler retaining bolt and spring.
12. Reinstall the exhaust springs.
13. Reinstall the exhaust sensor. **See Note At the top of page.** If the sensor has been rerouted, secure the wire as necessary (away from the exhaust) using cable or zip ties.
14. Reinstall the hood, gauge pod, storage bin, belt guard and side panels in the reverse order

**It is highly recommended to reinstall the OE muffler inlet heat shield assembly onto the MBRP Powersports muffler inlet. Minor trimming of the shield may be required to provide clearance around the exhaust sensor.**

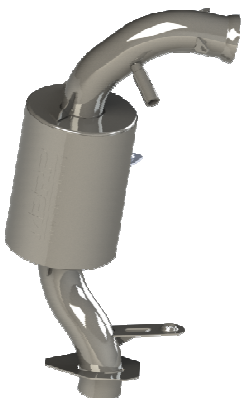

MBRP Powersports warranty applies for a one (1) year period from the date of purchase to defects in product material and workmanship and is to the original purchaser on record and for the original vehicle for which it was designed and installed. This warranty is limited, at MBRP Powersports sole determination, to the repair or replacement of defective product only and does not include the cost of removal or re-installation, damage by accident, abuse, misuse or misapplication or any consequential damages however they may arise. Determination of warranty coverage shall be at the discretion of an authorized MBRP Powersports quality engineer.

